

ACME-SHOREY

PRECAST CONCRETE PRODUCTS

WWW.ACMESHOREY.COM

PHONE (508) 548-9607

FAX (508) 548-1664

CARVER, MA
334 TREMONT STREET

HARWICH, MA
36 GREAT WESTERN ROAD

NOTES:

- 1.) CAN BE USED WITH 6" O.D. HIGHWAY CATCH BASINS.
- 2.) CAN BE USED WITH 6" O.D. LEACHING PITS.

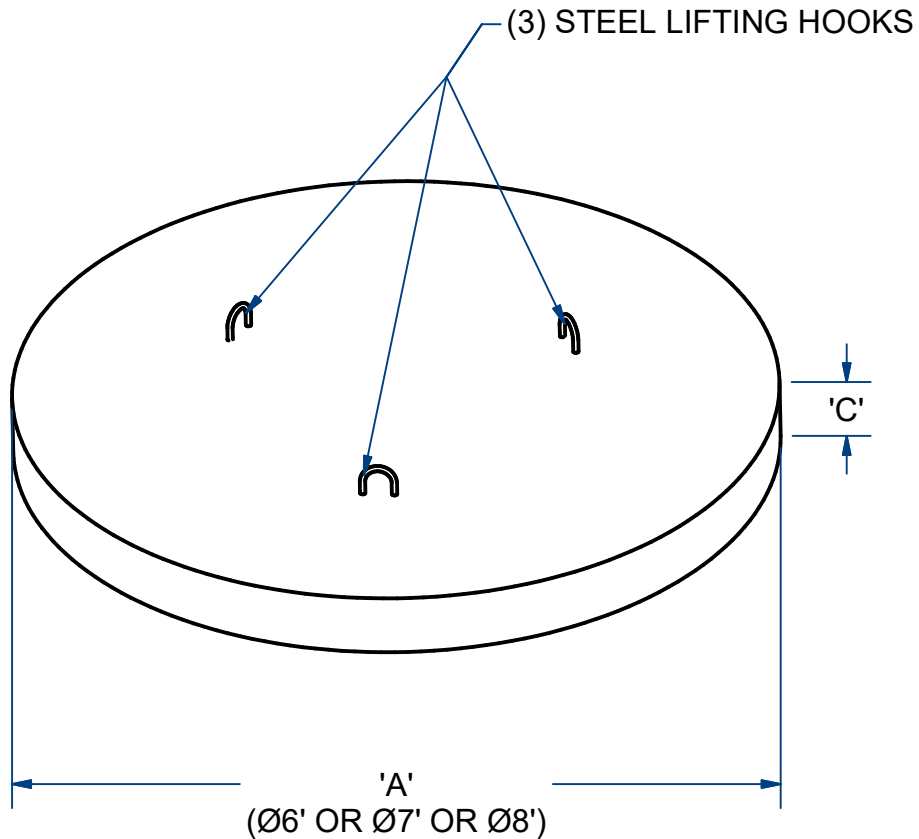

HIGHWAY CATCH BASIN BASE

H20

SEE CHART FOR SIZES

ITEM# HCBB

Wt. GRID Lbs

18 -4.3-4.8

Sht 1 of 2

ACME-SHOREY

PRECAST CONCRETE PRODUCTS

NOTES:

- 1.) CAN BE USED WITH 6" O.D. HIGHWAY CATCH BASINS.
- 2.) CAN BE USED WITH 6" O.D. LEACHING PITS.
- 3.) CAN HAVE Ø24" HOLE THRU CENTER AS REQ'D.

Part#	Description	A' (O.D.)	B' Thickness	C' (ACCESS)	Wt (Lbs)	Section
HCBB	Base,HCBB, Solid	ø6'	6"	None	2,040	18 - 4.3
HCBBC24	Base,HCBB	ø6'	6"	Ø24	1,900	18 - 4.4
HCBB7	Base,HCBB, Solid	ø7'	6"	None	2,813	18 - 4.5
HCBB7C24	Base,HCBB	ø7'	6"	Ø24	2,650	18 - 4.6
HCBB8	Base,HCBB, Solid	ø8'	8"	None	3,777	18 - 4.7
HCBB8C24	Base,HCBB	ø8'	8"	Ø24	3,540	18 - 4.8

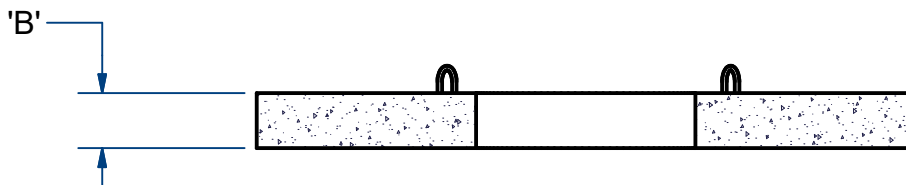
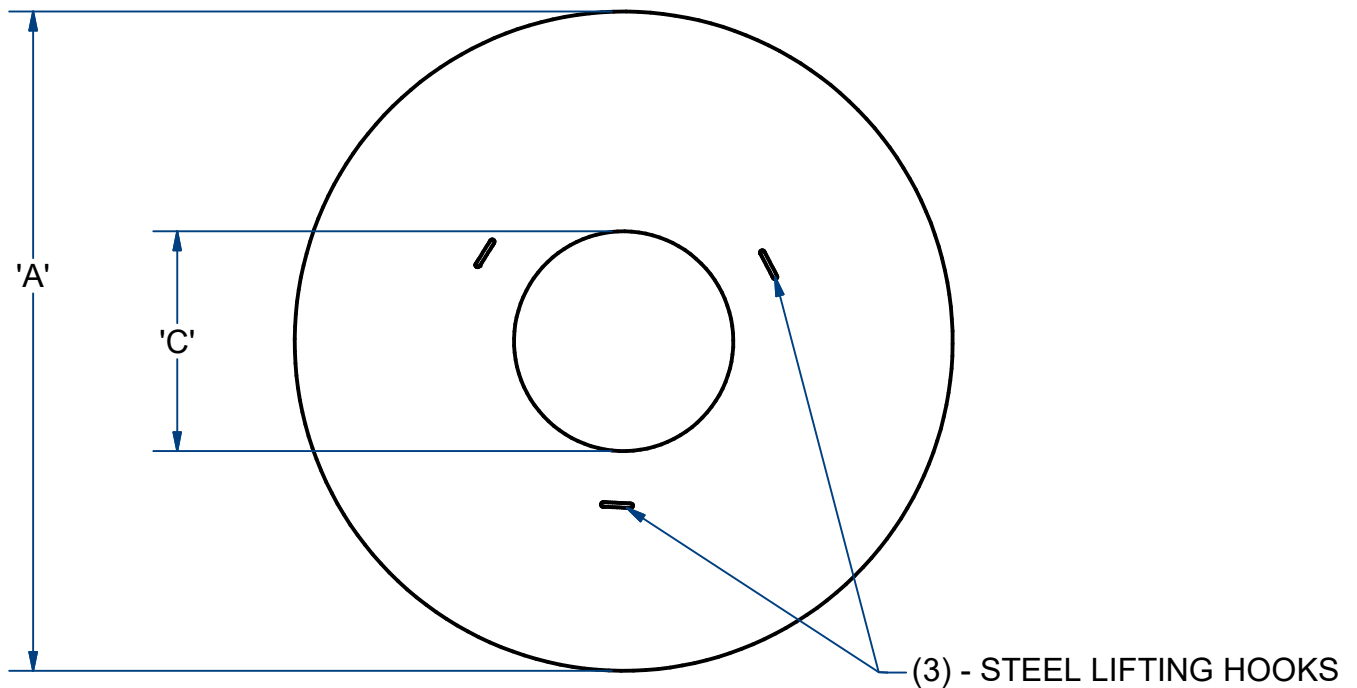

NAME: HIGHWAY CATCH BASIN BASE

H-20

ITEM# HCBB

Concrete Minimum Strength: 5,000 p.s.i. at 28 days
 Steel Reinforcement: ASTM A615, Grade 60
 Design Loading: standard units - AASHTO - H20

WEIGHT SEE GRID

CH

DATE: 8-23-23